

**THERMACUT® REPLACEMENT PARTS SUITABLE FOR
ESAB®/L-TEC®
PT-36™**

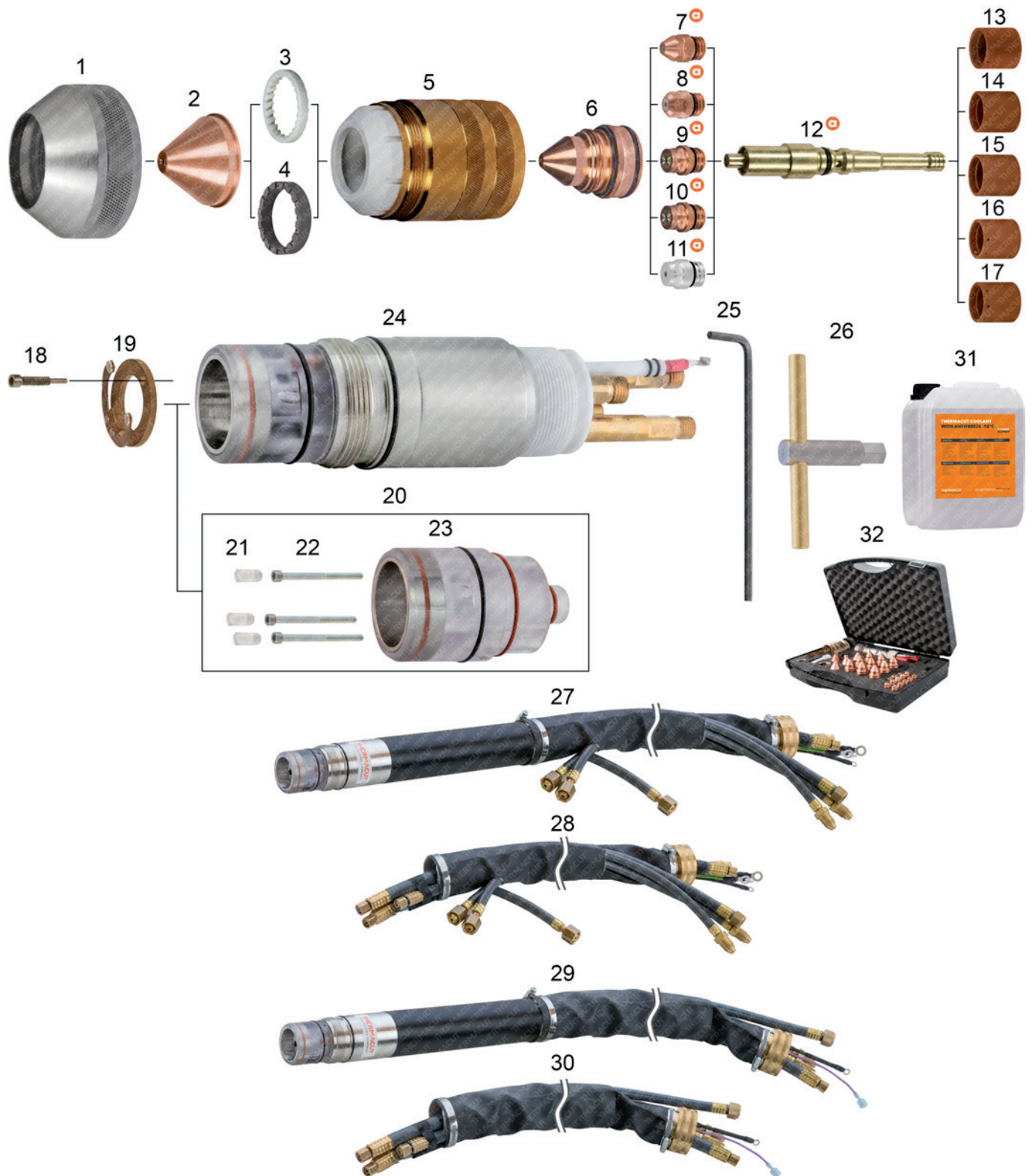

Last update of this page: 12/08/2019. See Revision history for details.

THERMACUT®
THE CUTTING COMPANY

WWW.THERMACUT.CZ
TEL.: +420 556 423 418
SALES@THERMACUT.CZ

WWW.THERMACUT.DE
TEL.: +49 (0) 27 39 40 33 0
INFO@THERMACUT.DE

WWW.THERMACUT.COM
TEL.: 1-603-542-6715
CUSTOMERSERVICE@THERMACUT.COM

THERMACUT®, THE CUTTING COMPANY®, FHT-EX®, EX-TRAFIRE®, EX-TRACK®, EX-TRABEAM® AND EX-TRAFAME® ARE REGISTERED TRADEMARKS OF THERMACUT, K.S. AND MAY BE REGISTERED IN CZECH REPUBLIC AND/OR OTHER COUNTRIES. ALL OTHER TRADEMARKS ARE PROPERTIES OF THEIR RESPECTIVE OWNERS. THERMACUT IS NO WAY AFFILIATED WITH ESAB®/L-TEC®. MOST THERMACUT PARTS ARE MADE FOR OR BY AN IBG COMPANY. PARTS INDICATED WITH A OEM ARE ORIGINAL PARTS MANUFACTURED BY THE ABOVE NAMED MANUFACTURER AND ARE BEING RESOLD BY THERMACUT. THERMACUT RESERVES THE RIGHT TO SUBSTITUTE OEM PARTS IN PLACE OF THERMACUT PARTS. VALID FROM NOVEMBER 2020 • PREVIOUS VERSION IS NO LONGER VALID. • © COPYRIGHT 2020 BY THERMACUT® CZECH REPUBLIC. ALL RIGHTS RESERVED.

**THERMACUT® REPLACEMENT PARTS SUITABLE FOR
ESAB®/L-TEC®
PT-36™**



PRODUCT BROCHURE WITH DETAILS AT
WWW.THERMACUT.COM

Item	Part No.	Ref. No.	Description	Std. Pkg.	Item	Part No.	Ref. No.	Description	Std. Pkg.
1.	T-10128	37081	Shield Retainer	1	17.	T-11119	0558002530	Gas Swirl Baffle, 8 × 0.047, 360-450A, CCW	1
2.	T-12231	0558009425	Micro Shield 2.5mm 30-60A MS	1	18.	T-11942	37073	Screw, Contact Ring	1
	T-10463	0558007624	Shield Cup 2.4mm 45-55A	1	19.	T-11863	0558003858	Cont. Ring with 2pcs. Screws 37073 (=37071)	1
	T-10333	0558006130	Shield Cup 3.0mm 35-50A	1	20.	T-12040	T-12040	Exchangeable Insulator Kit	1
	T-10332	0558006141	Shield Cup 4.1mm 70-280A	1	21.	PT-13160	0558001825-11	Plastic Screw	1
	T-10334	0558006166	Shield Cup 6.6mm 290-450A	1	22.	PT-13159	0558001825-10	Screw	1
	T-10335	0558006199	Shield Cup 9.9mm 300-600A	1	23.	PT-12123	0558001825-8	Insulator Body	1
3.	T-2269	21944	Diffuser 100-600A	1	24.	T-11208	0558003804	Torch Body PT-36™	1
	T-10331	22496	Diffuser 100-600A, CCW	1	25.	N-20426	93750010	Hex Key Wrench for Contact Ring	1
4.	T-2268	21796	Gas Diffuser 50A	1	26.	T-11665	0558003918 OEM	Electrode Holder Wrench	1
5.	T-10129	37082	Nozzle Retaining Cap, Standard	1	27.	KT-1452	0558006745	PT-36™ Mach. Torch with Leads 1.3m	1
6.	T-12229	0558009406	Micro Nozzle 0.6mm 30A MS/SS/AL	1		KT-1453	0558006746	PT-36™ Mach. Torch with Leads 1.8m	1
	T-12230	0558009410	Micro Nozzle 1.0mm 60A MS/SS/AL	1		KT-1454	0558006747	PT-36™ Mach. Torch with Leads 3.7m	1
	T-10336	0558006010	Nozzle 1.0mm 45/50A MS/SS/AL	1		KT-1455	0558006749	PT-36™ Mach. Torch with Leads 4.6m	1
	T-10337	0558006014	Nozzle 1.4mm 100A MS/AL (70/130A SS)	1		KT-1456	0558006750	PT-36™ Mach. Torch with Leads 5.2m	1
	T-10970	0558006018	Nozzle 1.8mm 100/130A MS (100A SS/AL)	1		KT-1457	0558006779	PT-36™ Mach. Torch with Leads 6.1m	1
	T-10338	0558006020	Nozzle 2.0mm 150/200A MS/AL (130/150A SS)	1		KT-1458	0558006751	PT-36™ Mach. Torch with Leads 7.6m	1
	T-10339	0558006023	Nozzle 2.3mm 200/280A MS (200A SS), (200/260A AL)	1	28.	KT-1460	0558007031	PT-36™ Cable Leads 1.3m	1
	T-10340	0558006025	Nozzle 2.5mm 280/290A MS (260A SS)	1		KT-1461	0558007032	PT-36™ Cable Leads 1.8m	1
	T-10443	0558006030	Nozzle 3.0mm 325/360A MS (360A SS/AL)	1		KT-1462	0558007034	PT-36™ Cable Leads 3.7m	1
	T-10341	0558006036	Nozzle 3.6mm 400A MS (450A SS)	1		KT-1463	0558007036	PT-36™ Cable Leads 4.6m	1
	T-10292	0558006041	Nozzle 4.1mm 600A SS/AL	1		KT-1464	0558007037	PT-36™ Cable Leads 5.2m	1
⊕ 7.	T-12228	⊕ 0558009400-PRO	Micro Electrode 30-60A MS/SS/AL	5		KT-1465	0558007038	PT-36™ Cable Leads 6.1m	1
⊕	T-11910	⊕ 0558003928-UR	Electrode, N ₂ /H35	5		KT-1466	0558007039	PT-36™ Cable Leads 7.6m	1
	T-10439	0558005459 OEM	Replaced by 0558003914-PRO	3		KT-1522	0558007035	PT-36™ Cable Leads 4.3m, Bevel	1
⊕ 8.	T-11303	⊕ T-11303-PRO	Electrode 50-250A, Silver PRO	5	29.	KT-1478	0558003849	PT-36™ Mach. Torch with Leads 1.4m	1
⊕ 9.	T-11290*	⊕ 0558003914-PRO	Electrode 100-450A, O ₂ , Silver PRO	5		KT-1479	0558003850	PT-36™ Mach. Torch with Leads 1.8m	1
⊕ 10.	T-11994	⊕ 0558012000-PRO	Electrode 100-450A, O ₂ , Silver PRO	5		KT-1480	0558003852	PT-36™ Mach. Torch with Leads 3.7m	1
⊕ 11.	T-11209**	⊕ 0558003914-AG	Electrode, Standard, O ₂	5		KT-1481	0558003853	PT-36™ Mach. Torch with Leads 4.6m	1
⊕ 12.	T-11319	⊕ 0558003924-UR	Electrode Holder	1		KT-1482	0558003854	PT-36™ Mach. Torch with Leads 5.2m	1
13.	T-10693	0558005457 OEM	Gas Swirl Baffle, 4 × 0.022, 35-70A	1		KT-1483	0558003856	PT-36™ Mach. Torch with Leads 7.6m	1
14.	T-4607	0558002534	Gas Swirl Baffle, 4 × 0.032, 100-280A, CCW	1	30.	Cable Leads are available on request, because of more possible types of fittings.			
15.	T-4606	0558002533	Gas Swirl Baffle, 4 × 0.032, 100-280A	1	31.	Coolant Liquid. Details on the page 152, section Accessories.			
16.	T-4636	0558001625	Gas Swirl Baffle, 8 × 0.047, 300-600A	1	32.	Consumable Case. Details on the page 158, section Accessories.			

* A UNIQUE DESIGN WHICH ENHANCES PERFORMANCE AND DIFFERS FROM OEM DESIGNS

** AVAILABILITY ON REQUEST

⊕ MUST BE USED AS A SET OF ELECTRODE HOLDER AND ELECTRODE, THIS COMPLETE SET IS INTERCHANGEABLE AND COMPATIBLE WITH ORIGINAL PARTS.

CCW COUNTER CLOCK WISE GAS SWIRLING, USE OF CCW PARTS WILL MAKE CUT ANGLE ON THE OPPOSITE SIDE, THAN WITH STANDARD CLOCK WISE (CW) SWIRLING PARTS.

-PRO SILVER PRO TECHNOLOGY INCREASES ELECTRODE LIFETIME SIGNIFICANTLY COMPARED TO STANDARD COPPER ELECTRODES

Last update of this page: 12/08/2019. See Revision history for details.

THERMACUT®
THE CUTTING COMPANY

WWW.THERMACUT.CZ
TEL.: +420 556 423 418
SALES@THERMACUT.CZ

WWW.THERMACUT.DE
TEL.: +49 (0) 27 39 40 33 0
INFO@THERMACUT.DE

WWW.THERMACUT.COM
TEL.: 1-603-542-6715
CUSTOMERSERVICE@THERMACUT.COM

THERMACUT®, THE CUTTING COMPANY®, FHT-EX®, EX-TRAFIRE®, EX-TRACK®, EX-TRABEAM® AND EX-TRAFLEAME® ARE REGISTERED TRADEMARKS OF THERMACUT, K.S. AND MAY BE REGISTERED IN CZECH REPUBLIC AND/OR OTHER COUNTRIES. ALL OTHER TRADEMARKS ARE PROPERTIES OF THEIR RESPECTIVE OWNERS. THERMACUT IS NO WAY AFFILIATED WITH ESAB®/L-TEC®. MOST THERMACUT PARTS ARE MADE FOR OR BY AN IBG COMPANY. PARTS INDICATED WITH A OEM ARE ORIGINAL PARTS MANUFACTURED BY THE ABOVE NAMED MANUFACTURER AND ARE BEING RESOLD BY THERMACUT. THERMACUT RESERVES THE RIGHT TO SUBSTITUTE OEM PARTS IN PLACE OF THERMACUT PARTS. VALID FROM NOVEMBER 2020 • PREVIOUS VERSION IS NO LONGER VALID. • © COPYRIGHT 2020 BY THERMACUT® CZECH REPUBLIC. ALL RIGHTS RESERVED.