

**THERMACUT® REPLACEMENT PARTS SUITABLE FOR
ESAB®/L-TEC®
PT-600™**

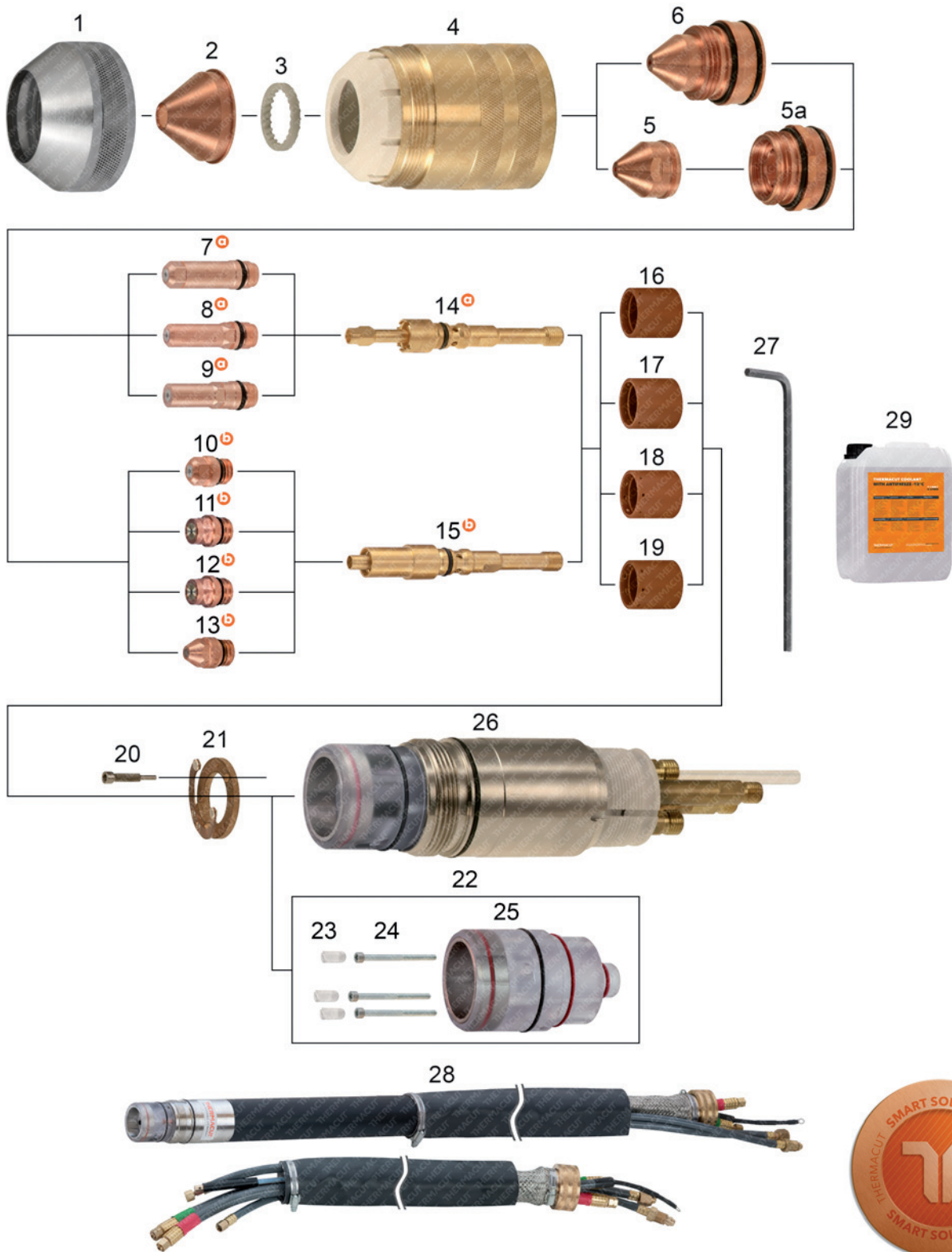

Last update of this page: 02/02/2018. See Revision history for details.

THERMACUT®
THE CUTTING COMPANY

WWW.THERMACUT.CZ
TEL.: +420 556 423 418
SALES@THERMACUT.CZ

WWW.THERMACUT.DE
TEL.: +49 (0) 27 39 40 33 0
INFO@THERMACUT.DE

WWW.THERMACUT.COM
TEL.: 1-603-542-6715
CUSTOMERSERVICE@THERMACUT.COM

THERMACUT®, THE CUTTING COMPANY®, FHT-EX®, EX-TRAFIRE®, EX-TRACK®, EX-TRABEAM® AND EX-TRAFLEAME® ARE REGISTERED TRADEMARKS OF THERMACUT, K.S. AND MAY BE REGISTERED IN CZECH REPUBLIC AND/OR OTHER COUNTRIES. ALL OTHER TRADEMARKS ARE PROPERTIES OF THEIR RESPECTIVE OWNERS. THERMACUT IS NO WAY AFFILIATED WITH ESAB®/L-TEC®. MOST THERMACUT PARTS ARE MADE FOR OR BY AN IBG COMPANY. PARTS INDICATED WITH A OEM ARE ORIGINAL PARTS MANUFACTURED BY THE ABOVE NAMED MANUFACTURER AND ARE BEING RESOLD BY THERMACUT. THERMACUT RESERVES THE RIGHT TO SUBSTITUTE OEM PARTS IN PLACE OF THERMACUT PARTS. VALID FROM NOVEMBER 2020 • PREVIOUS VERSION IS NO LONGER VALID. • © COPYRIGHT 2020 BY THERMACUT® CZECH REPUBLIC. ALL RIGHTS RESERVED.

THERMACUT® REPLACEMENT PARTS SUITABLE FOR ESAB®/L-TEC® PT-600™



PRODUCT BROCHURE WITH DETAILS AT
WWW.THERMACUT.COM

Item	Part No.	Ref. No.	Description	Std. Pkg.	Item	Part No.	Ref. No.	Description	Std. Pkg.
1.	T-10128	37081	Shield Retainer	1	b 12.	T-11994	b 0558012000-PRO	Electrode 100-450A, O ₂ , Silver PRO	5
2.	T-2266	21802	Shield 100-250A	1	b 13.	T-11910	b 0558003928-UR	Electrode, N ₂ /H35	5
	T-2267	21945	Shield 360A	1		T-10439	0558005459 OEM	Replaced by 0558003914-PRO	3
	T-4580	21795 OEM	Shield 50A	5	a 14.	T-11201	a 0558001621	Electrode Holder	1
NS	T-10124	0558004678	Precision Shield 110-200A		b 15.	T-11210	b T-11210	Electrode Holder	1
3.	T-2269	21944	Diffuser 100-600A	1	16.	T-4606	0558002533	Gas Swirl Baffle, 4 hole × 0.032, CW	1
	T-10331	22496	Diffuser 100-600A, CCW	1	17.	T-4607	0558002534	Gas Swirl Baffle, 4 hole × 0.032, CCW	1
NS	T-2268	21796	Gas Diffuser 50A	1	18.	T-4636	0558001625	Gas Swirl Baffle, 8 hole × 0.047, CW	1
4.	T-10129	37082	Nozzle Retaining Cap	1	19.	T-11119	0558002530	Gas Swirl Baffle, 8 Hole × 0.047, CCW	1
5.	T-1720	22026	Nozzle Tip 50A	5	20.	T-11942	37073	Screw	1
	T-1717	22029	Nozzle Tip 100A	5	21.	T-11863	0558003858	Cont. Ring with 2pcs. Screws 37073(=37071)	1
	T-1718	22030	Nozzle Tip 150A	5	22.	T-12040	T-12040	Exchangeable Insulator Kit	1
	T-1719	22031	Nozzle Tip 200A	5	23.	PT-13160	0558001825-11	Plastic Screw	1
5a.	T-1721	22027	Nozzle Base 50A	1	24.	PT-13159	0558001825-10	Screw	1
	T-1722	22028	Nozzle Base 100-250A	1	25.	PT-12123	0558001825-8	Insulator Body	1
6.	T-5331	0558001881	Nozzle 50A	1	26.	T-10283	0558001825	Torch Body	1
	T-5332	0558001882	Nozzle 100A	1	NS	T-11202	T-11202	Electrode Holder Wrench	1
	T-5333	0558001883	Nozzle 150A	1	NS	KT-1178	996248	PT-600™ Hose, power, 1.8m	1
	T-5334	0558001884	Nozzle 200A	1	NS	KT-1176	34360	PT-600™ Hose, plas., 1.8m	1
	T-5330	0558001623	Nozzle 250A	1	NS	KT-1189	33209	PT-600™ Hose, power, 4.6m	1
	T-5335	0558001885	Nozzle 360A	1	NS	KT-1330	33211	PT-600™ Hose, power, 7.6m	1
	T-5336	0558001886	Nozzle 400A	1	NS	KT-1177	37357	PT-600™ Cable, pilot, 2m	1
	T-5337	0558001887	Nozzle 600A	1	27.	N-20426	93750010	Hex Key Wrench for Contact Ring	1
a 7.	T-11239	0558001624-PRO	a Electrode 250A, Silver PRO	5	28.	Cable Leads are available on request, because of more possible types of fittings.			
a 8.	T-11240	T-11240-PRO	a Electrode 260/400A, Silver PRO	5	29.	Coolant Liquid. Details on the page 152, section Accessories.			
a 9.	T-11238	0558002516-PRO	a Electrode 360/400A, Silver PRO	5					
b 10.	T-11303	T-11303-PRO	b Electrode 50-250A, Silver PRO	5					
b 11.	T-11290*	0558003914-PRO	b Electrode 100-450A, O ₂ , Silver PRO	5					

a MUST BE USED ONLY AS A SET OF ELECTRODE HOLDER 0558001621 AND 0558001624-PRO, T-11240-PRO, 0558002516-PRO ELECTRODES.

b MUST BE USED ONLY AS A SET OF ELECTRODE HOLDER T-11210 AND T-11303-PRO, 0558003914-PRO, 0558012000-PRO, 0558003928-UR ELECTRODES.

* A UNIQUE DESIGN WHICH ENHANCES PERFORMANCE AND DIFFERS FROM OEM DESIGNS

CCW COUNTER CLOCK WISE GAS SWIRLING, USE OF CCW PARTS WILL MAKE CUT ANGLE ON THE OPPOSITE SIDE, THAN WITH STANDARD CLOCK WISE (CW) SWIRLING PARTS.

NS NOT SHOWN IN THE PICTURE

-PRO TECHNOLOGY OF SILVER INSERTED COPPER ELECTRODE BODY, WHICH SIGNIFICANTLY DECREASES ELECTRODE COSTS WITH SIMILAR WORK PERFORMANCE COMPARED TO FULL SILVER ELECTRODES.

SMART SOLUTION - DESIGN IMPROVEMENTS THAT BRINGS ADDED VALUE SUCH AS IMPROVED LIFETIME OF CONSUMABLES, EXCELLENT CUT QUALITY, SPEED OR BETTER COST EFFECTIVENESS OF YOUR SYSTEM

Last update of this page: 02/02/2018. See Revision history for details.

THERMACUT
THE CUTTING COMPANY

WWW.THERMACUT.CZ
TEL.: +420 556 423 418
SALES@THERMACUT.CZ

WWW.THERMACUT.DE
TEL.: +49 (0) 27 39 40 33 0
INFO@THERMACUT.DE

WWW.THERMACUT.COM
TEL.: 1-603-542-6715
CUSTOMERSERVICE@THERMACUT.COM

THERMACUT®, THE CUTTING COMPANY®, FHT-EX®, EX-TRAFIRE®, EX-TRACK®, EX-TRABEAM® AND EX-TRAFAME® ARE REGISTERED TRADEMARKS OF THERMACUT, K.S. AND MAY BE REGISTERED IN CZECH REPUBLIC AND/OR OTHER COUNTRIES. ALL OTHER TRADEMARKS ARE PROPERTIES OF THEIR RESPECTIVE OWNERS. THERMACUT IS NO WAY AFFILIATED WITH ESAB®/L-TEC®. MOST THERMACUT PARTS ARE MADE FOR OR BY AN IBG COMPANY. PARTS INDICATED WITH A OEM ARE ORIGINAL PARTS MANUFACTURED BY THE ABOVE NAMED MANUFACTURER AND ARE BEING RESOLD BY THERMACUT. THERMACUT RESERVES THE RIGHT TO SUBSTITUTE OEM PARTS IN PLACE OF THERMACUT PARTS. VALID FROM NOVEMBER 2020 • PREVIOUS VERSION IS NO LONGER VALID. • © COPYRIGHT 2020 BY THERMACUT® CZECH REPUBLIC. ALL RIGHTS RESERVED.