

**THERMACUT® REPLACEMENT PARTS SUITABLE FOR
KJELLBERG®
FineFocus® 450
PB-S47™ W - 1 / O₂**

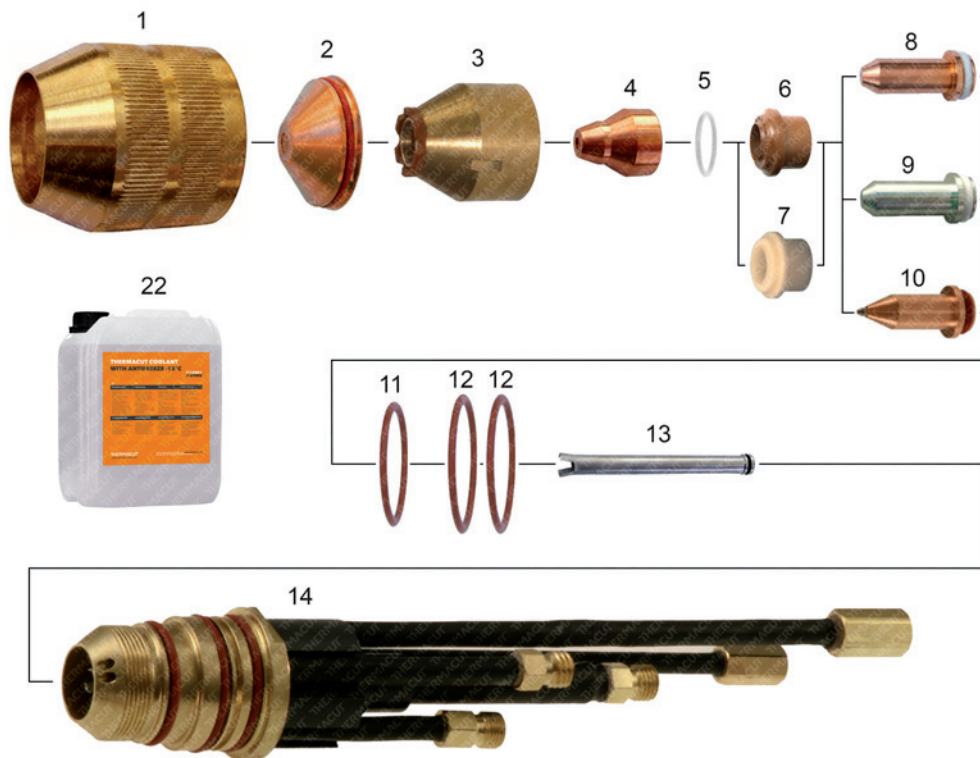

1:3



Last update of this page: 01/11/2020. See Revision history for details.

THERMACUT®
THE CUTTING COMPANY

WWW.THERMACUT.CZ
TEL.: +420 556 423 418
SALES@THERMACUT.CZ

WWW.THERMACUT.DE
TEL.: +49 (0) 27 39 40 33 0
INFO@THERMACUT.DE

WWW.THERMACUT.COM
TEL.: 1-603-542-6715
CUSTOMERSERVICE@THERMACUT.COM

THERMACUT®, THE CUTTING COMPANY®, FHT-EX®, EX-TRAFIRE®, EX-TRACK®, EX-TRABEAM® AND EX-TRAFLEAME® ARE REGISTERED TRADEMARKS OF THERMACUT, K.S. AND MAY BE REGISTERED IN CZECH REPUBLIC AND/OR OTHER COUNTRIES. ALL OTHER TRADEMARKS ARE PROPERTIES OF THEIR RESPECTIVE OWNERS. THERMACUT IS NO WAY AFFILIATED WITH KJELLBERG®.
MOST THERMACUT PARTS ARE MADE FOR OR BY AN IBG COMPANY. PARTS INDICATED WITH A OEM ARE ORIGINAL PARTS MANUFACTURED BY THE ABOVE NAMED MANUFACTURER AND ARE BEING RESOLD BY THERMACUT. THERMACUT RESERVES THE RIGHT TO SUBSTITUTE OEM PARTS IN PLACE OF THERMACUT PARTS.
VALID FROM NOVEMBER 2020 • PREVIOUS VERSION IS NO LONGER VALID. • © COPYRIGHT 2020 BY THERMACUT® CZECH REPUBLIC. ALL RIGHTS RESERVED.

**THERMACUT® REPLACEMENT PARTS SUITABLE FOR
KJELLBERG®
FineFocus® 450
PB-S47™ W - 1 / O₂**

Item	Part No.	Ref. No.	Sh.Ref.No.	Description	Std.Pkg.	Item	Part No.	Ref. No.	Sh.Ref.No.	Description	Std.Pkg.
1.	T-8641	11.832.201.081	W501	Protection Cap	1	10.	T-8735	11.828.211.5001	Ka	Cathode, ArH2 (i)	5
2.	T-8642	11.832.201.1561	W4130	Swirl Gas Cup 3.0	10	11.	T-8602	10.575.052		O-Ring	1
	T-8643	11.832.201.1571	W4140	Swirl Gas Cup 4.0	10	12.	T-8647	10.505.915		O-Ring	1
3.	T-8644	11.832.201.160	W3030	Nozzle Cap	1	13.	PT-10232	11.832.201.152	W901	Cooling Tube	1
4.	T-8614	11.828.203.410	Lle	Nozzle 1.0mm 45A, Lle, Air	10	14.	T-8649	11.832.221.100		Torch Body, Machine	1
	T-8615	11.828.203.413	Lde	Nozzle 1.3mm 90A, Lde, Air	10	15.	T-8648	10.505.948		O-Ring	1
	T-8616	11.828.203.414	Lee	Nozzle 1.4mm 130A, Lee, Air	10	16.	T-10193	11.832.221.100-10		Tube Adaptor	1
	T-8620	11.834.321.410	Lle-XL	Nozzle 1.0mm 45A, O ₂	10	17.	T-10925	11.832.201.077		Clamping Bush	1
	T-8621	11.834.321.413	Lde-XL	Nozzle 1.3mm 90A, O ₂	10	18.	T-10924	11.832.201.076		Outer Bush	1
	T-8622	11.834.321.414	Lee-XL	Nozzle 1.4mm 130A, O ₂	10	19.	T-10772	11.834.321.250		Tube PB-S47W™	1
	T-8736	11.828.213.613	Ade	Nozzle 1.3mm 80A, ArH2	10	20.	KT-1155	11.834.721.1015		Torch with Leads 1.5m 2/O ₂	1
	T-8737	11.828.213.614	Aee	Nozzle 1.4mm 100A, ArH2	5	21.	KT-1056	11.834.321.006		Torch with Leads 6m 1/O ₂	1
	T-8738	11.828.213.616	Afe	Nozzle 1.6mm 130A, ArH2	5		KT-1422	11.834.321.010		Torch with Leads 10m 1/O ₂	1
5.	T-8601	10.575.036		O-Ring	1		KT-1102	11.834.321.015		Torch with Leads 15m 1/O ₂	1
6.	T-8618	11.834.321.153	Z111	Swirl Ring	1		KT-1127	K.PB-S47W.20M		Torch with Leads 20m 1/O ₂	1
7.	T-9287	11.834.321.153K	Z111	Swirl Ring, Ceramic	1	NS	KT-1470	11.834.321.701A		PB-S47W™ Cable Leads 15m 1/O ₂	1
8.	T-8619	11.834.321.3001	Kb-XL	Cathode	5	NS	T-13187	11.834.721.700B		PB-S47W™ Cable Leads 1.5m 2/O ₂	1
9.	T-4921	11.834.321.3001-AG	Kb-XL	Cathode, SilverEX-®	5	22.	Coolant Liquid. Details on the page 152, section Accessories.				

(i) THIS PART MAY NOT BE DISTRIBUTED ON THE GERMAN MARKET. THERMACUT ACCEPTS NO RESPONSIBILITY IN CASE OF INDIRECT SALES TO GERMANY.

NS NOT SHOWN IN THE PICTURE

Last update of this page: 01/11/2020. See Revision history for details.

THERMACUT®
THE CUTTING COMPANY™

WWW.THERMACUT.CZ
TEL.: +420 556 423 418
SALES@THERMACUT.CZ

WWW.THERMACUT.DE
TEL.: +49 (0) 27 39 40 33 0
INFO@THERMACUT.DE

WWW.THERMACUT.COM
TEL.: 1-603-542-6715
CUSTOMERSERVICE@THERMACUT.COM

THERMACUT®, THE CUTTING COMPANY®, FHT-EX®, EX-TRAFIRE®, EX-TRACK®, EX-TRABEAM® AND EX-TRAFLEAME® ARE REGISTERED TRADEMARKS OF THERMACUT, K.S. AND MAY BE REGISTERED IN CZECH REPUBLIC AND/OR OTHER COUNTRIES. ALL OTHER TRADEMARKS ARE PROPERTIES OF THEIR RESPECTIVE OWNERS. THERMACUT IS NO WAY AFFILIATED WITH KJELLBERG®.
MOST THERMACUT PARTS ARE MADE FOR OR BY AN IBG COMPANY. PARTS INDICATED WITH A OEM ARE ORIGINAL PARTS MANUFACTURED BY THE ABOVE NAMED MANUFACTURER AND ARE BEING RESOLD BY THERMACUT. THERMACUT RESERVES THE RIGHT TO SUBSTITUTE OEM PARTS IN PLACE OF THERMACUT PARTS.
VALID FROM NOVEMBER 2020 • PREVIOUS VERSION IS NO LONGER VALID. • © COPYRIGHT 2020 BY THERMACUT® CZECH REPUBLIC. ALL RIGHTS RESERVED.