

**THERMACUT® REPLACEMENT PARTS SUITABLE FOR
TRAFIMET®
A90™/P90™**

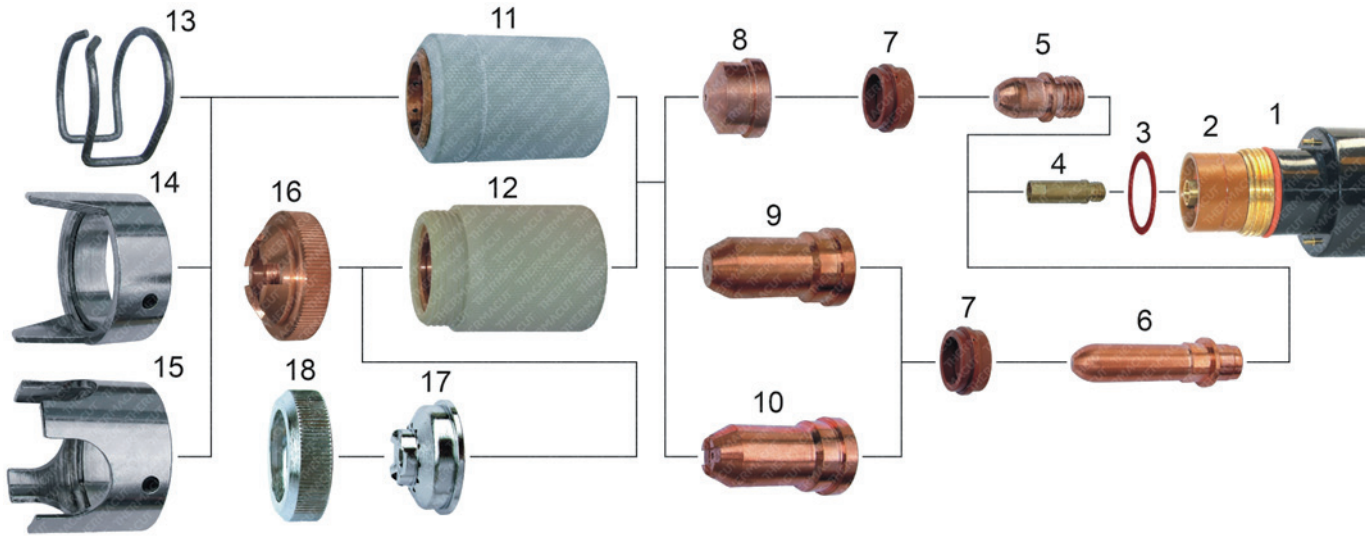

Item	Part No.	Ref. No.	Description	Std. Pkg.	Item	Part No.	Ref. No.	Description	Std. Pkg.
1.	TN-0147	PF109	Torch Body, Hand (part 2, 3 included)	1	11.	T-3714	PC109	Nozzle Retaining Cap	6
2.	T-9793	60085	Insulator	1	12.	T-5015	PC113	Contact Nozzle Ret. Cap	6
3.	T-3562	EA131	O-Ring	1	13.	T-3718	CV11	Spacer Spring	5
4.	PT-10709	45244-7	Diffusor	1	14.	T-0643	CV12(1408)	Spacer, Double Pointed	1
5.	T-5059	PR101	Electrode	10	15.	T-5003	CV14	Crown Spacer	6
6.	T-5065	PR116	Electrode, Long - no thread	5	16.	T-5004	CV23	Shield Cup	6
7.	T-5072	PE101	Swirl Ring	2	17.	T-9370		Spacer for Contact Cutting	1
8.	T-2926	PD101-11	Nozzle 1.1mm	5	18.	T-9375		Locking Nut	1
	T-3349	PD101-14	Nozzle 1.4mm	5	NS	T-5069	TP12	Insulating Sleeve	1
	T-2955	PD101-17	Nozzle 1.7mm	5	NS	T-5068	TP10	Handle with Switch	1
9.	T-5032	PD117-14	Nozzle 1.4mm, Long	10	NS	KT-1182	PA109	A90™ Hand Torch with Leads 6m, fittings	1
	T-5033	PD117-17	Nozzle 1.7mm, Long	10	NS	KT-1375	PA213	A90™ Hand Torch with Leads 6m with centr. conn.	1
	T-5034	PD117-19	Nozzle 1.9mm, Long	10					
10.	T-9527	PD111	Nozzle, Gouging	1					

NS NOT SHOWN IN THE PICTURE

Last update of this page: 02/07/2018. See Revision history for details.

THERMACUT®
THE CUTTING COMPANY

WWW.THERMACUT.CZ
TEL.: +420 556 423 418
SALES@THERMACUT.CZ

WWW.THERMACUT.DE
TEL.: +49 (0) 27 39 40 33 0
INFO@THERMACUT.DE

WWW.THERMACUT.COM
TEL.: 1-603-542-6715
CUSTOMERSERVICE@THERMACUT.COM

THERMACUT®, THE CUTTING COMPANY®, FHT-EX®, EX-TRAFIRE®, EX-TRACK®, EX-TRABEAM® AND EX-TRAFLEAME® ARE REGISTERED TRADEMARKS OF THERMACUT, K.S. AND MAY BE REGISTERED IN CZECH REPUBLIC AND/OR OTHER COUNTRIES. ALL OTHER TRADEMARKS ARE PROPERTIES OF THEIR RESPECTIVE OWNERS. THERMACUT IS NO WAY AFFILIATED WITH TRAFIMET®.
MOST THERMACUT PARTS ARE MADE FOR OR BY AN IBG COMPANY. PARTS INDICATED WITH A OEM ARE ORIGINAL PARTS MANUFACTURED BY THE ABOVE NAMED MANUFACTURER AND ARE BEING RESOLD BY THERMACUT. THERMACUT RESERVES THE RIGHT TO SUBSTITUTE OEM PARTS IN PLACE OF THERMACUT PARTS.
VALID FROM NOVEMBER 2020 • PREVIOUS VERSION IS NO LONGER VALID. • © COPYRIGHT 2020 BY THERMACUT® CZECH REPUBLIC. ALL RIGHTS RESERVED.